

(5 to 6 circuits)

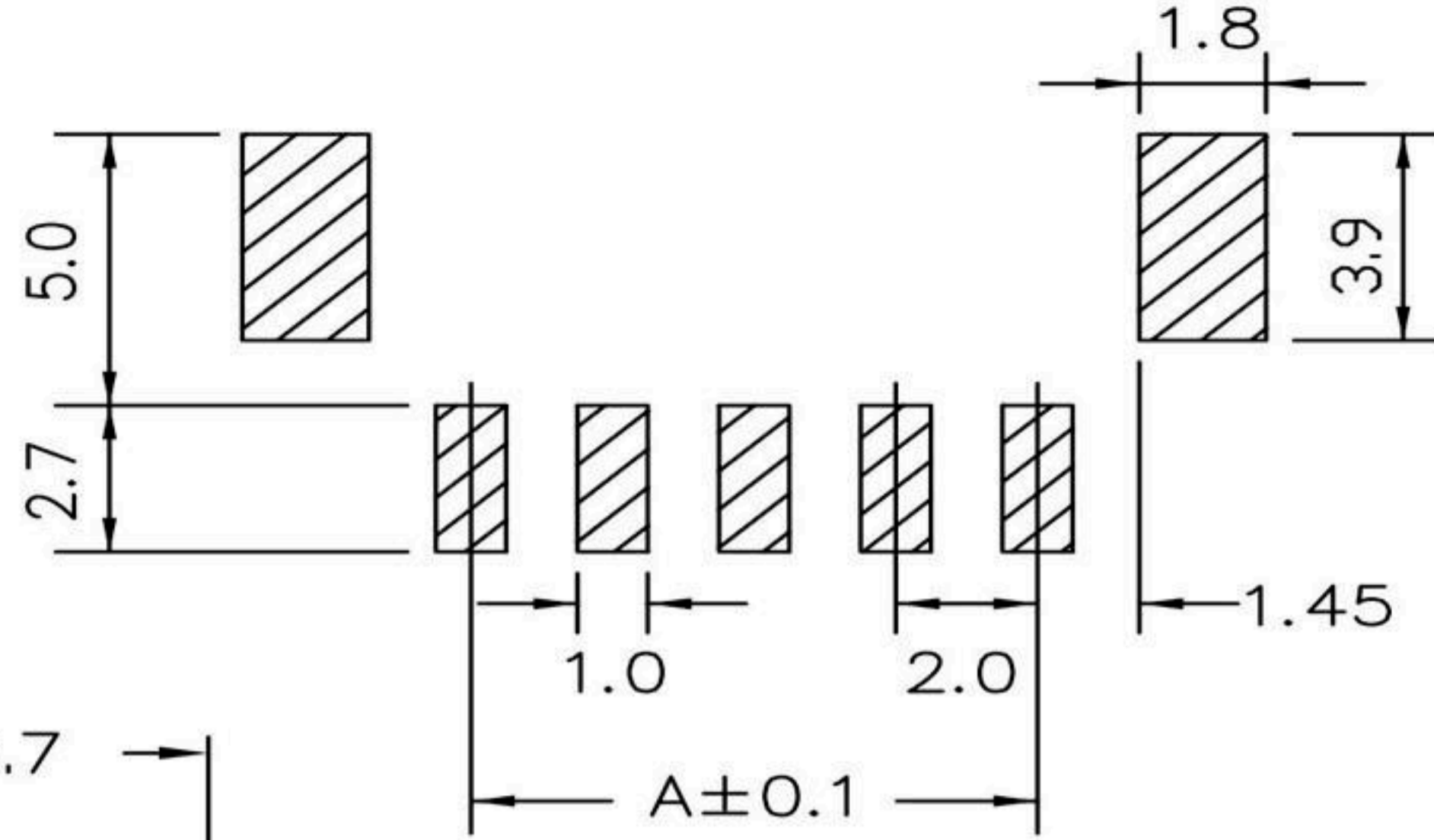
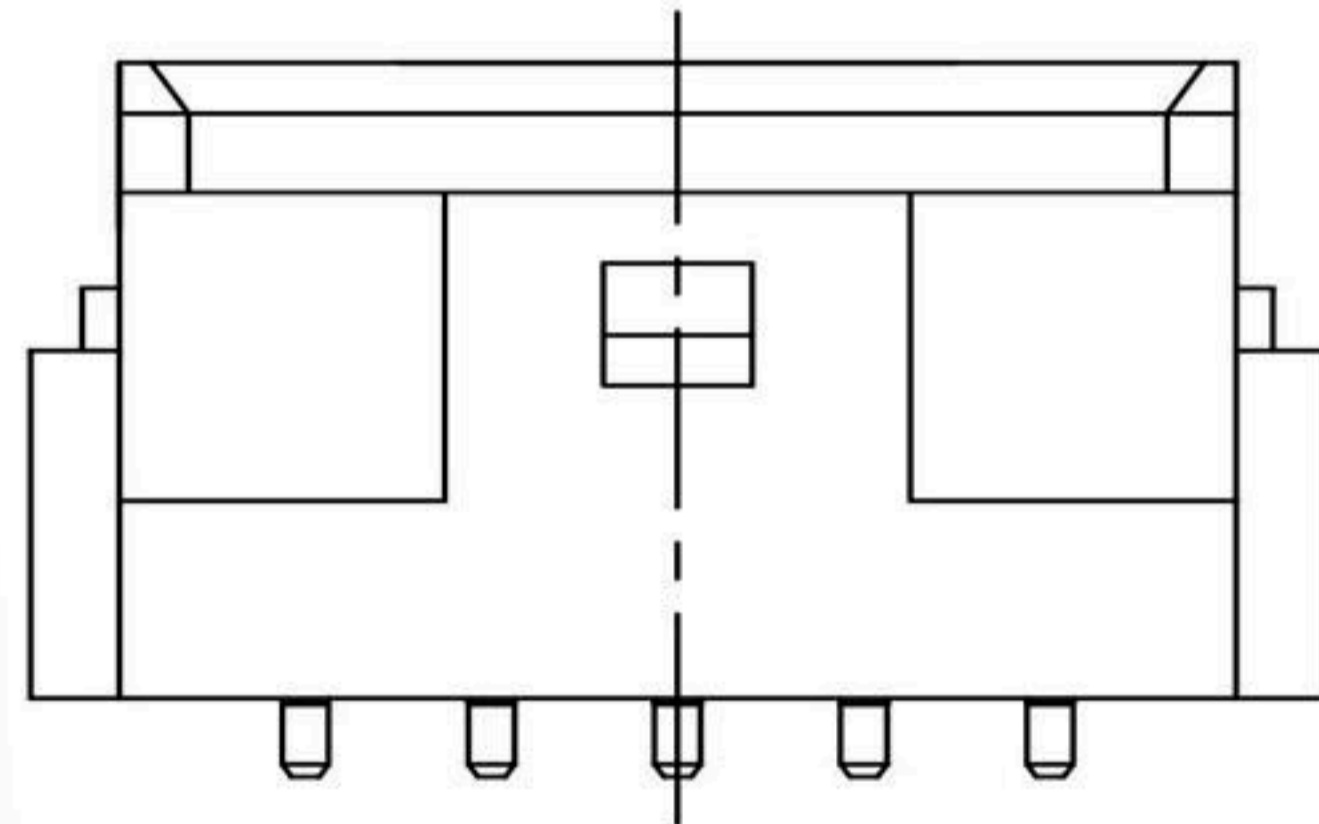
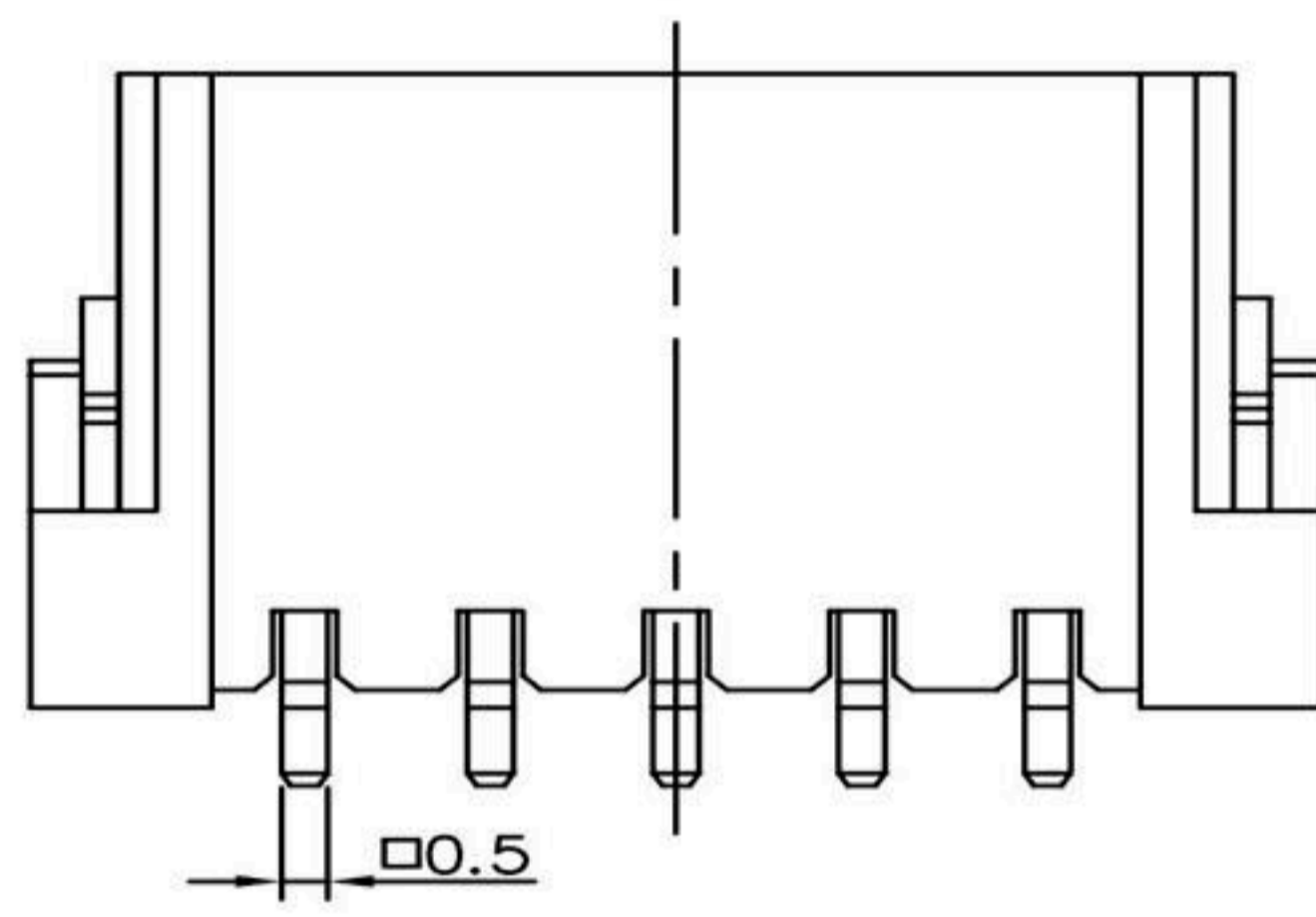
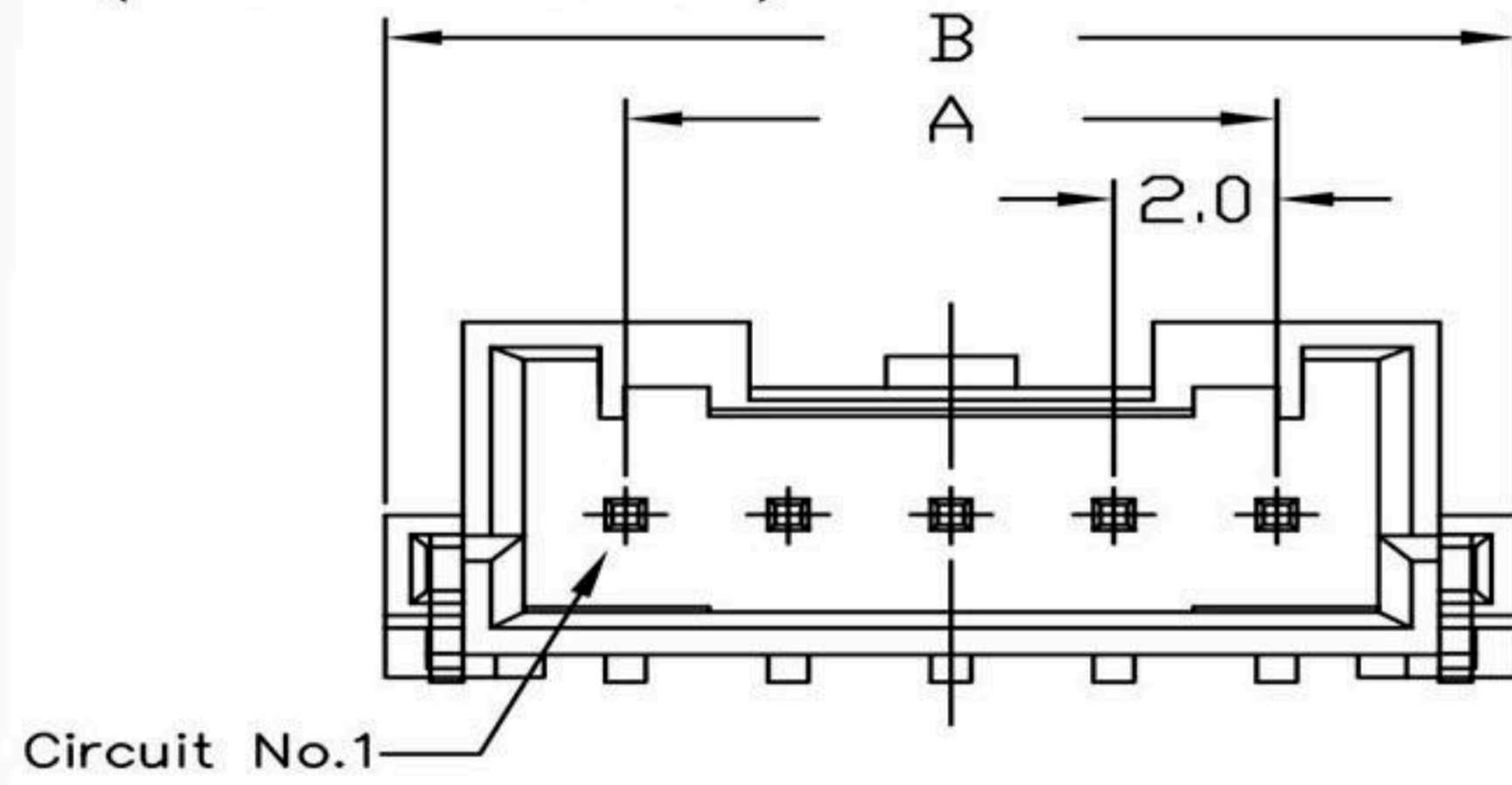

RECOMMENDED P.C.BOARD LAYOUT DIMM.

### Specifications

Current Rating: 3A AC/ DC (Max)AWG#22  
 Voltage Rating: 250V AC/ DC  
 Temperature Range: -25°C ~ + 85°C  
 Contact Resistance: 20mΩ Max  
 Insulation Resistance: 1000MΩ Min  
 Withstanding Voltage:800V AC/Minute  
 Pin : Brass/ Tin-plated/ Gold-flash  
 Wafer Material: Nylon 6T,UL94V-0,natural  
 Solder tab:Brass/Tin-plated

Poles	Dimension mm (in.)	
	A	B
5	8.0(0.315)	14.0(0.551)
6	10.0(0.394)	16.0(0.630)

RoHS  
Compliant

**HSM** 玄茂科技股份有限公司  
**HSUAN MAO TECHNOLOGY CO., LTD.**

APPD. 核准  
 DWG. 製圖 *Helen*  
 DATE 制表日  
 2013/6/10

SCALE 比例 參考  
 UNIT 單位 MM  
 PAGE 張數 1 OF 1

TOLERANCE 容許公差  
 .0 ± 0.25  
 .00 ± 0.2  
 ANG. ±  
 SIZE. 紙張尺寸 A4  
 REV. 版本 A

PART NAME 品名  
 JST PA 2.0mm WAFER 1X(5~6)P SMT RIGHT  
 ANGLE TYPE TIN PLATING WHITE INSULATOR ROHS

PART NO. 料號  
 W2112-(5~6)PBTWX0R