

Ordering & Dimensional Information (mm)

Part No.	Wire range	Max. Dia. Of Insulation	Q'ty/Reel	Dimension			
				a	b	c	d
T2512-TPJ00000R	#22 ~ #28	φ 1.9mm	10,000	1.7	1.8	2.3	2.4
T2512-TPZ00000R	#20 ~ #22	φ 2.1mm	10,000	1.8	1.8	2.4	2.8

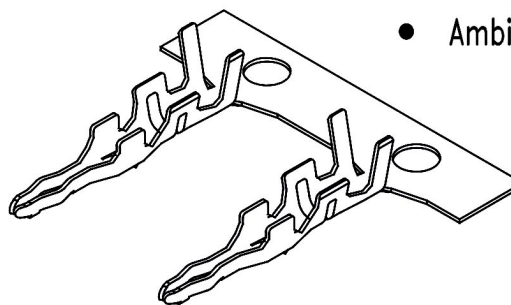
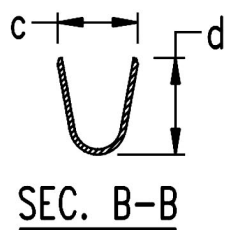
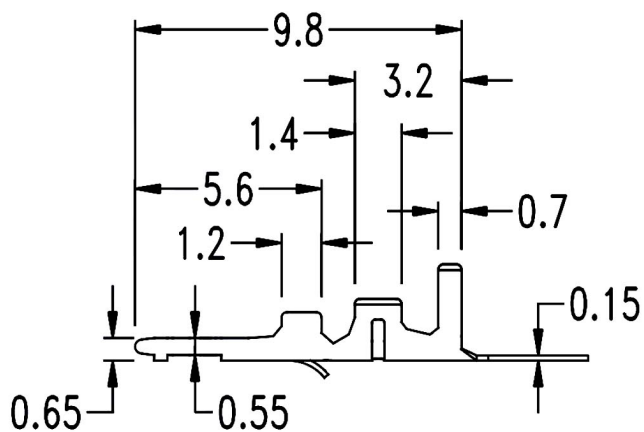
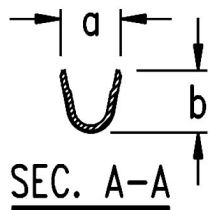
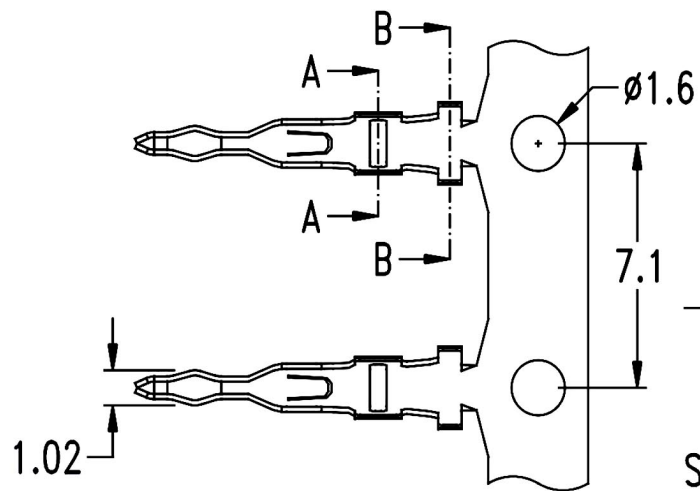

Features:

- Material: Phosphor bronze
- Finished: Tin-plated

Specification:

- Current rating: 3A AC, DC
- Voltage rating: 250V AC, DC
- Ambient temperature range: -40°C ~ 105°C

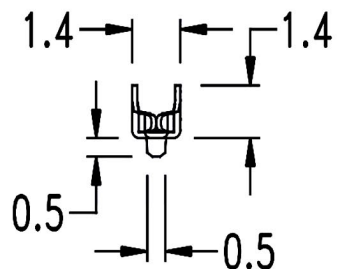

RoHS Compliant		HSM 玄茂科技股份有限公司 HSUAN MAO TECHNOLOGY CO., LTD.	
APPD. 核准	SCALE 比例 参考	UNLESS OTHERWISE SPECIFIED TOLERANCE .000 ± 0.08 (mm) .00 ± 0.25 (mm) .0 ± 0.4 (mm)	PART NAME 品名 2.5mm Board-In Type Terminal 180° Material: Phosphor Bronze Tin Plating ROHS
DWG. 製圖 Betty	UNIT 單位 M M	SIZE 紙張尺寸 A 4	PART NO.
DATE 制表日 2019/12/25	PAGE 張數 1 OF 1	REV. 版次 A	料號 T2512-TPX00000R