

Without locking ring.

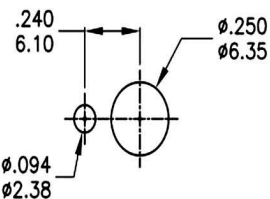

With standard locking ring.

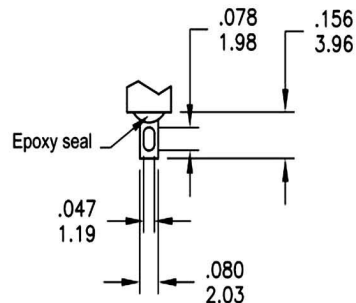

SOLDER LUG

Model No.	POS.1	POS.2	POS.3
	ON	ON	ON
Term. Comm.	2-3,5-6 8-9,11-12	2-3,5-4 8-9,10-11	2-1,5-4 8-7,11-10
SCHEMATIC			

SWITCH FUNCTION

PANEL MOUNTING

**SPECIFICATIONS**

**MECHANICAL LIFE:** 40,000 make-and-break cycles.  
**CONTACT RESISTANCE:** 10mΩ max. initial @ 2-4VDC  
 100mA for both silver and gold plated contacts.  
**INSULATION RESISTANCE:** 1,000MΩ min.  
**DIELECTRIC STRENGTH:** 1,000 V RMS@seal level.  
**OPERATING TEMPERATURE:** -30°C to 85°C.

**RATING :** 2Amps @250VAC  
 5Amps @120 VAC or 28 VDC

**MATERIALS**

**CASE:** Dially phthalate (DAP) (UL94v-0).  
**ACTUATOR:** Brass,chrome plated.  
**BUSHING:** Brass,nickel plated.  
**HOUSING:** Stainless Steel.  
**TERMINAL/CONTACT:** Silver or gold plated.

RoHS  
Compliant

**HSM 玄茂科技股份有限公司**  
**HSUAN MAO TECHNOLOGY CO., LTD.**

APPD. 核准  
Betty  
DATE 制表日  
2019/08/06

TOLERANCE (公差):  
0.00 mm ± 0.25mm  
0.0 mm ± 0.40mm  
ANGULAR: ±5°  
SCALE 比例 参考  
UNIT 單位 M M  
PAGE 張數 1 OF 1

PART NAME 品名  
Miniature Toggle Switches Switch Function:4P3T On-On-On  
Actuator Heigh:10.41mm Bushing:8.89mm High,Keyway  
Termination:Solder Lug Silver Plating Seal:With EPOXY ROHS  
PART NO.  
料號 C9901-46AB1T1VY0R