

- NOTES:
1. Rating: 300V 20A (IEC250V 24A)  
PITCH: 5mm
  2. Insulation Withstands Voltage:  
AC 2000V at 1 minute
  3. Insulation Resistance:  
500M  $\Omega$  or more at DC500V
  4. Using Temperature Range:  
-40°C ~ +105°C
  5. Suitable Electric Wire:  
24~12AWG (IEC 0.5~2.5mm<sup>2</sup>)
  6. Torque Value: 0.5 N·m
  7. RoHS compliance

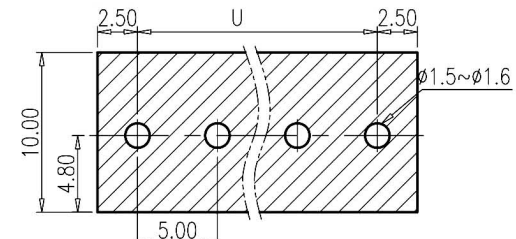

**PCB LAYOUT**

Normal Geometric Tolerancing				
—	//	≡	⊥	
0 to 100	0.2	0.3	0 to 10	0.2
over 100 to 150	0.3		over 10	0.3
Total Pitch Tolerances		Normal dimension Tolerances		
0<U<=30	±0.20	0~30	±0.25	
30<U<=53	±0.25	over 30~53	±0.30	
53<U<=70	±0.30	over 53~70	±0.35	
70<U<=90	±0.35	over 70~90	±0.44	
90<U<=115	±0.44	over 90~115	±0.55	
115<U<=150	±0.55	over 115~150	±0.70	

ITEM	NAME OF PART	MATERIAL	NOTES
4	SCREW	STEEL	Zn Plated
3	WIRE CAGE	STEEL	Zn Plated
2	SOLDER POST	COPPER ALLOY	Tin Plated
1	HOUSING	PA66	UL94-V0 GREEN

P	2	3	4	5	6	7	8	9	10	11	12	13
U	5.00	10.00	15.00	20.00	25.00	30.00	35.00	40.00	45.00	50.00	55.00	60.00
V	10.00	15.00	20.00	25.00	30.00	35.00	40.00	45.00	50.00	55.00	60.00	65.00
P	14	15	16	17	18	19	20	21	22	23	24	25
U	65.00	70.00	75.00	80.00	85.00	90.00	95.00	100.00	105.00	110.00	115.00	120.00
V	70.00	75.00	80.00	85.00	90.00	95.00	100.00	105.00	110.00	115.00	120.00	125.00

RoHS Compliant

**HSM** 玄茂科技股份有限公司

**HSUAN MAO TECHNOLOGY CO., LTD.**

APPD. 核准		TOLERANCE 容許公差	PART NAME 品名
DWG. 製圖	SCALE 比例	.0 ± 0.30 .00 ± 0.20 ANG. ± 3°	5.0mm TERMINAL BLOCK XXP STRAIGHT TYPE H=13.8mm SUITABLE FOR 12~24AWG TIN PLATING GREEN COLOR ROHS
DATE 制表日	UNIT 單位	SIZE 紙張尺寸	PART NO.
2015/03/10	PAGE 張數	M M A 4	料號 C0928-XXS5TE00R
	1 OF 1	REV. 版次	
		C	