

ELECTRICAL CHARACTERISTICS

Contact Current Rating: 3Amperes.
 Dielectric Withstanding Voltage: AC 500V at sea level.
 Insulation Resistance: 1000Megohms Min.
 Contact Resistance: 25Milliohms Max.
 Operation Temperature: -55°C to +105°C.

Material

Contact :Copper Alloy.
 Insulator:PBT.
 Shell: SPCC.
 Screw: Copper Alloy.

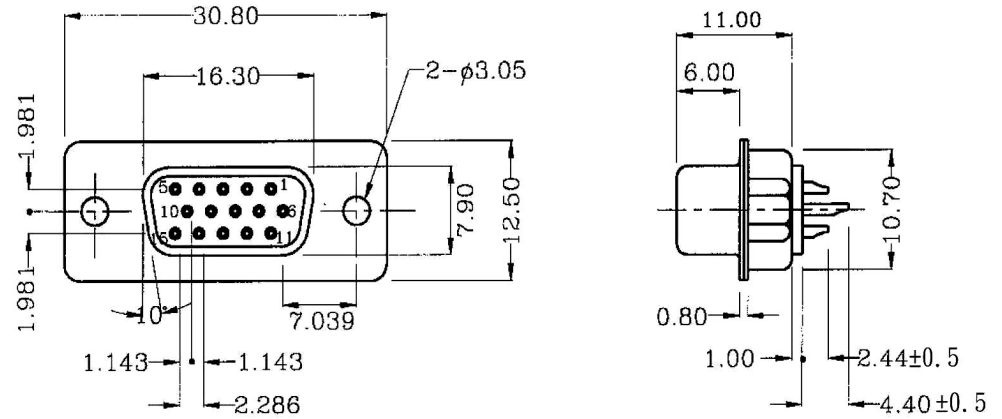

RoHS Compliant		HSM 玄茂科技股份有限公司 HSUAN MAO TECHNOLOGY CO., LTD.	
APPD. 核准 BETTY	SCALE 比例 参考	TOLERANCE 容許公差 .0 ±0.30 .00 ±0.25 ANG. ±2°	PART NAME 品名 H.D. D-SUB SOLDER TYPE STAMPED PIN 15P FEMALE REAR RIVET 3.8mm(4mm) OPEN HEX RIVET ROHS
DWG. 製圖 KAREN		UNIT 單位 MM	SIZE. 紙張尺寸 A 4
DATE 制表日 2011/11/23	PAGE 張數 1 OF 1	REV. 版次 B	PART NO. 料號 C0560-15FCEXXXR