

**ELECTRICAL CHARACTERISTICS**

Contact Current Rating: 3Amperes.  
 Dielectric Withstanding Voltage: AC 500V at sea level.  
 Insulation Resistance: 1000Megohms Min.  
 Contact Resistance: 30Milliohms Max.  
 Operation Temperature : -55°C to +105°C.

**Material**

Contact :Copper Alloy.  
 Insulator:PBT. (Select PA6T /LCP /PA9T)  
 Shell: SPCC.  
 Z-Piece: Copper Alloy.  
 Screw: Copper Alloy.  
 Rivet: Copper Alloy. or Zinc.

**Note:**

No.	A	B	C
09	16.92	24.99	30.81
15	25.25	33.32	39.14
25	38.96	47.04	53.04
37	55.42	63.50	69.32

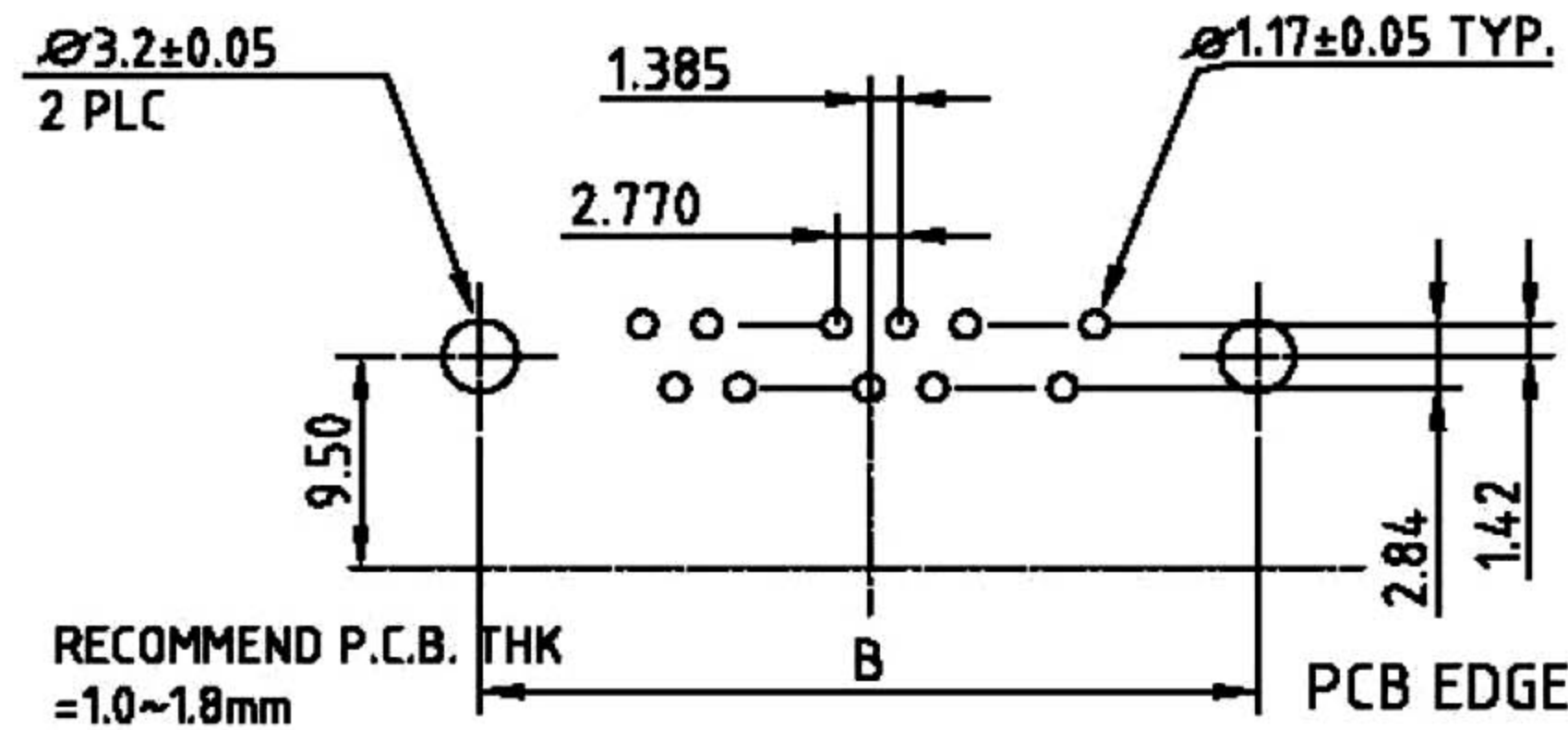
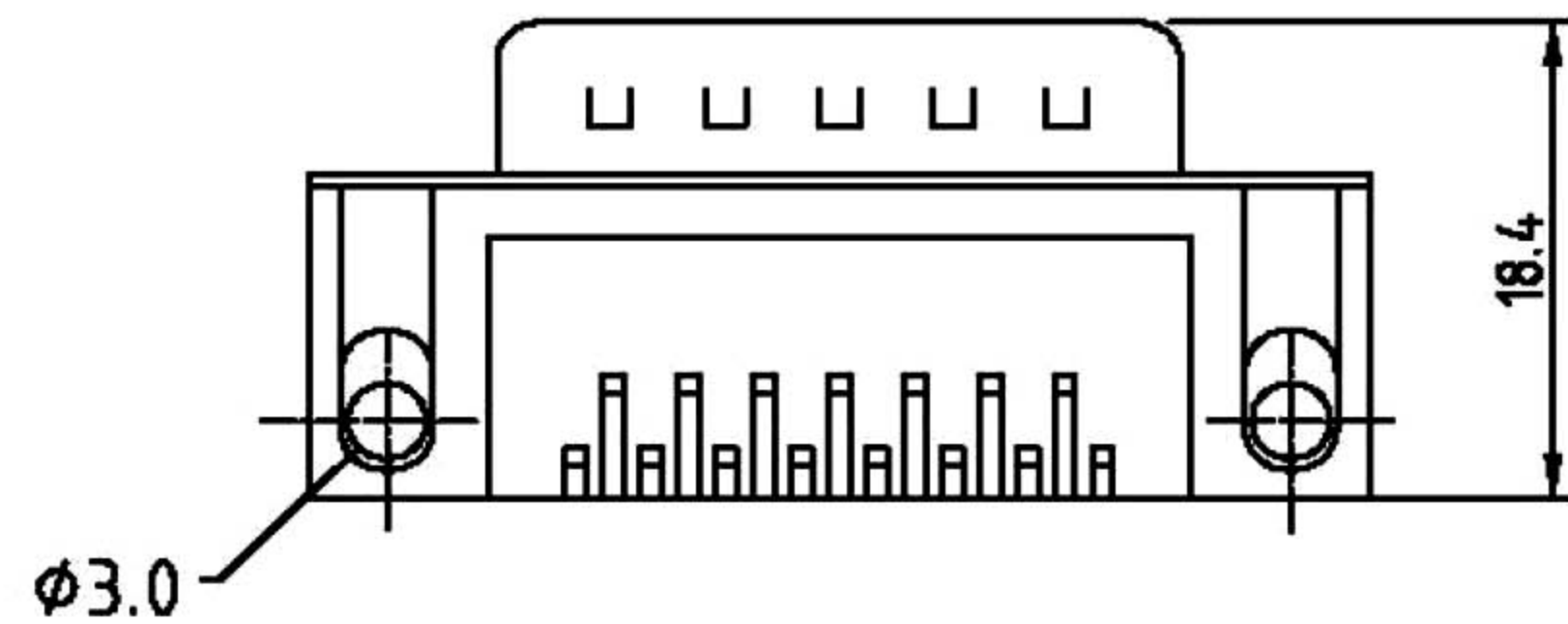

C0550-XXMECXXXR  
 C0550-XXMEEXXXR

C0550-XXMEBXXXR  
 C0550-XXMEDXXXR

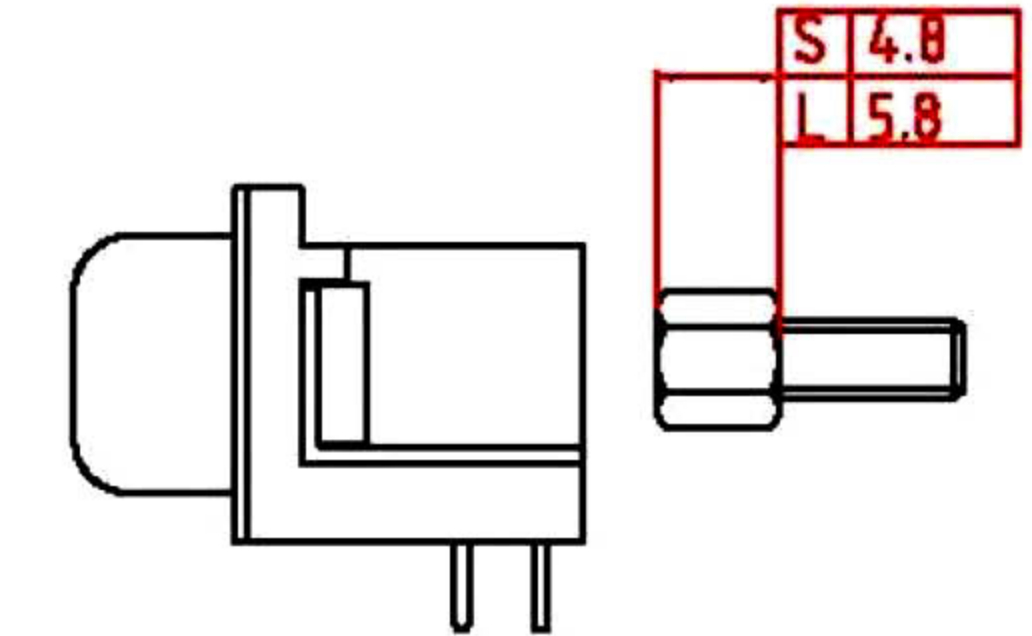
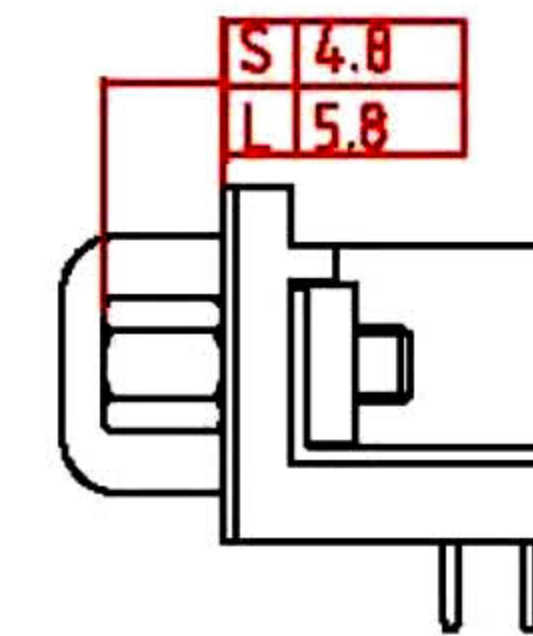

RoHS Compliant		<b>HSM</b> 玄茂科技股份有限公司 HSUAN MAO TECHNOLOGY CO., LTD.	
APPD. 核准 BETTY	SCALE 比例 參考	TOLERANCE .X ±0.30 .XX ±0.25 .XXX ±0.150 Ang. ±2°	PART NAME 品名 D-SUB PCB RIGHT ANGLE 7.2mm STAMPED PIN XXP MALE RIVET W/NON THREAD L-SHAPE ROHS LOW-LEAD
DWG. 製圖 KAREN	UNIT 單位 MM	SIZE. 紙張尺寸 A4	PART NO. 料號 C0550-XXMEXXXXR
DATE 制表日 2012/10/22	PAGE 張數 1 OF 1	REV. 版次 B	