

1 2 3 4 5 6 7 8

A
B
C
D
E
F
G
H

A
B
C
D
E
F
G
H

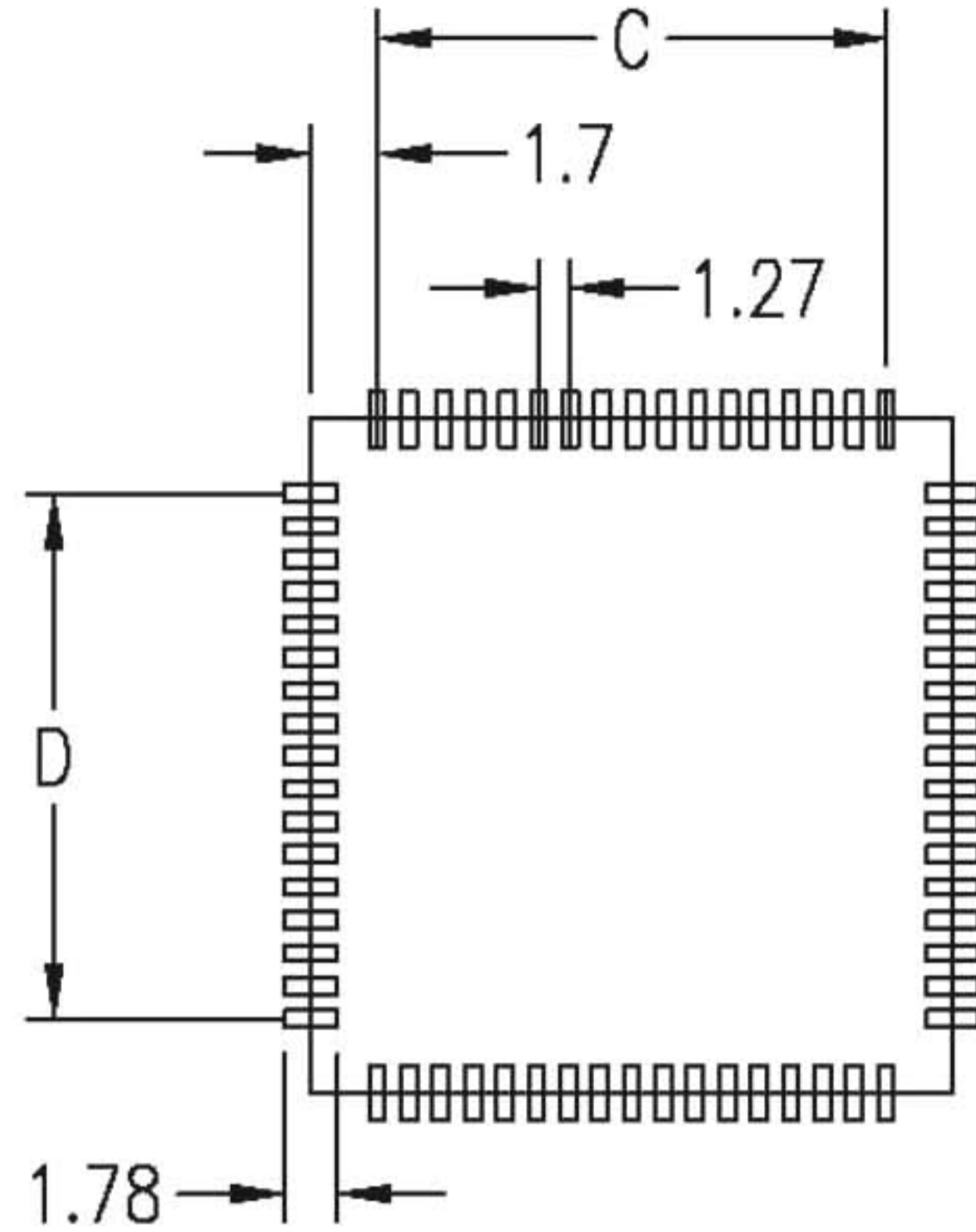
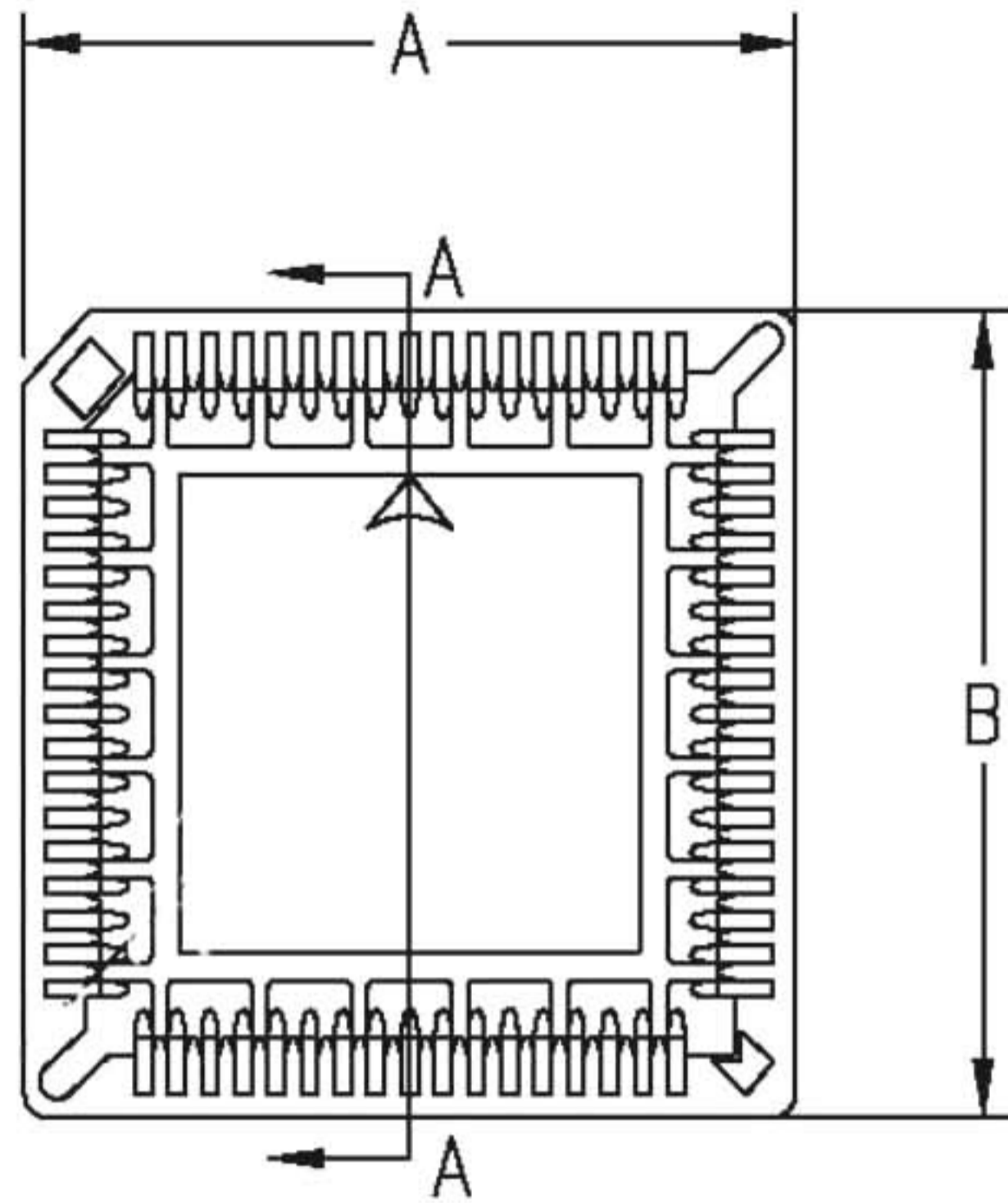

P.C.B LAYOUT

NO OF CONTACT	A±0.3	B±0.3	C±0.3	D±0.3	E±0.3
20	15.24	15.24	5.08	5.08	16.70
28	17.78	17.78	7.62	7.62	20.30
52	25.74	25.74	15.24	15.24	31.13
68	30.82	30.82	20.32	20.32	38.31
84	35.90	35.90	25.40	25.40	45.50

Insulator Material: PPS&40% Glass Fiber (UL 94 – V0)
 Contact Resistance: 30MΩ Max at Dc 100ma
 Insulator Resistance: 1000MΩ Min at Dc 500V
 Current Rating: 1AMP
 Dielectric Withstand Voltage: AC 500V for 1 minute
 Temperature Rating: -55 deg C ~+ 105 deg C
 Contact Material: Phosphor Bronze

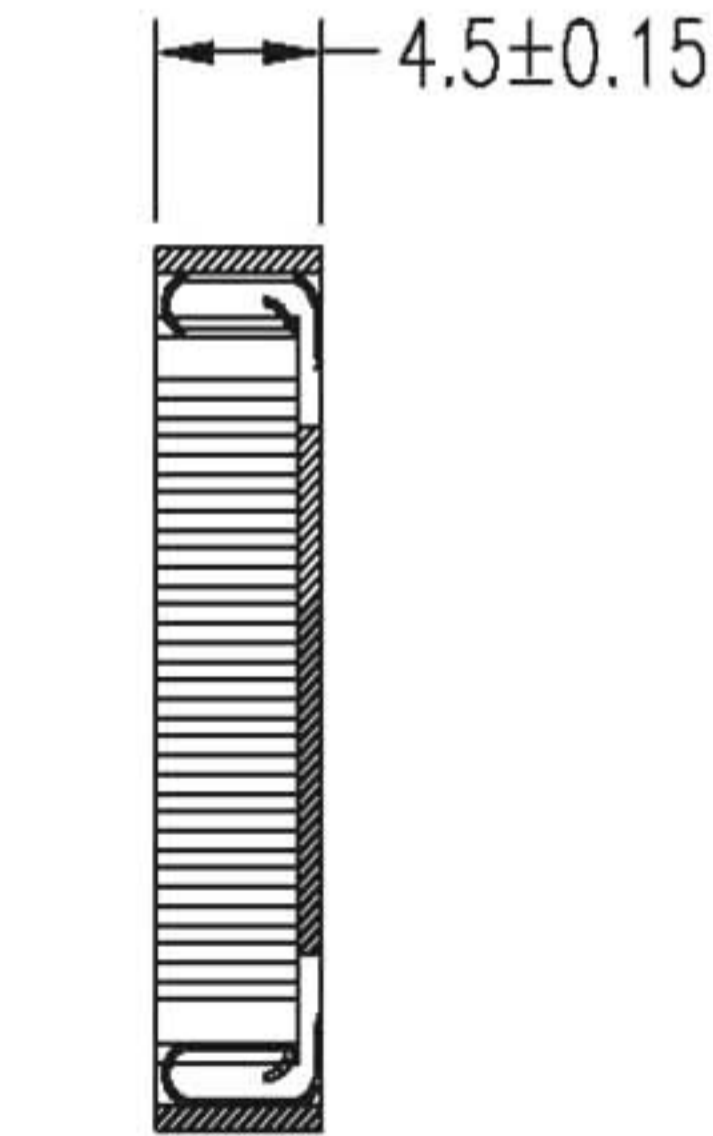
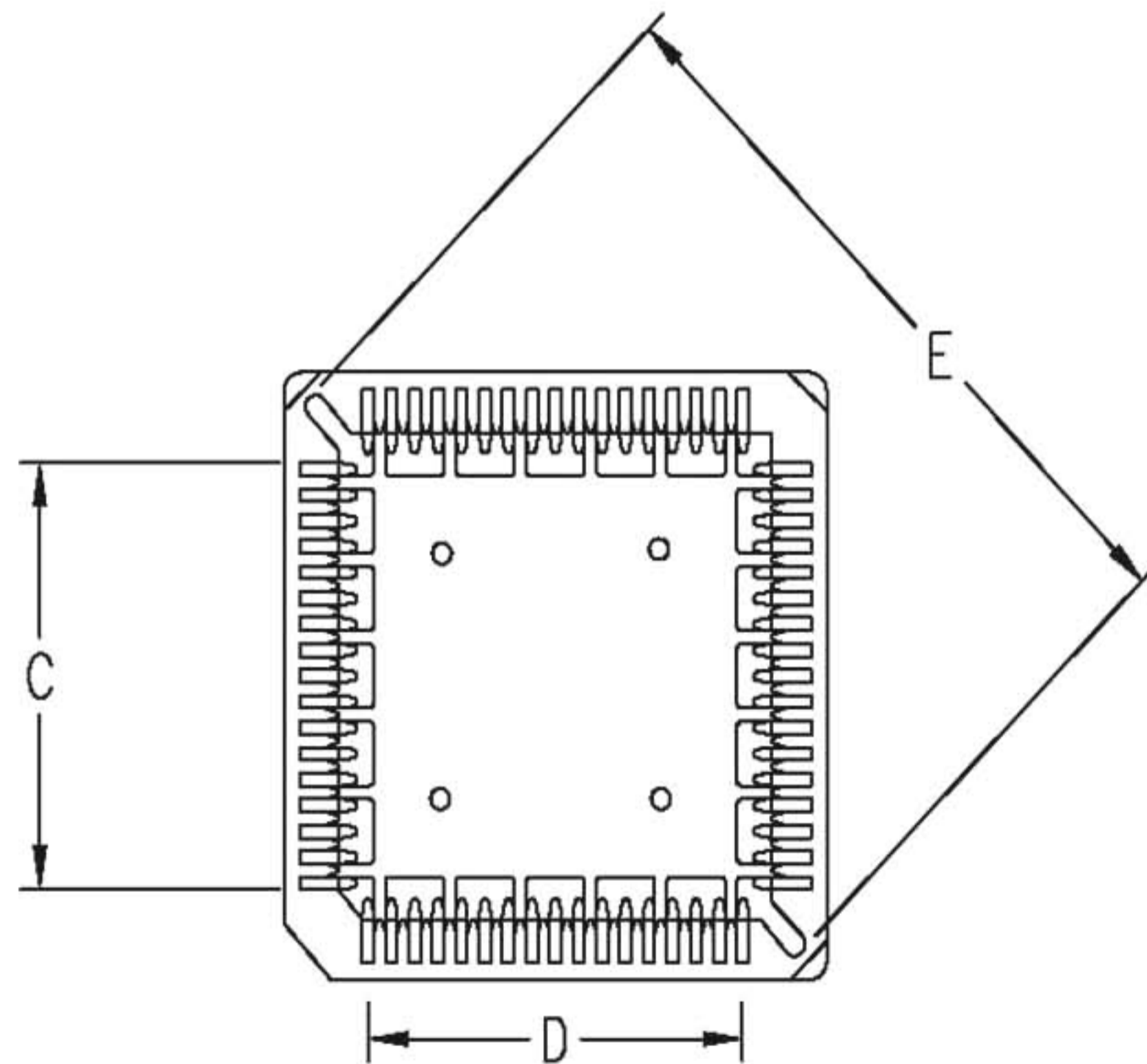

SECTION A-A

RoHS Compliant		HSM 玄茂科技股份有限公司 HSUAN MAO TECHNOLOGY CO., LTD.	
APPD. 核准 DWG. 製圖 DATE 制表日	SCALE 比例 UNIT 單位 PAGE 張數	TOLERANCE 容許公差 .0 ± 0.3 .00 ± 0.2 ANG. ± 0.2 SIZE 紙張尺寸 A4 REV. 版本 A	PART NAME 品名 PLCC SOCKET SMT TYPE 1.27mm XXP W/O POLARIZATION PEG TUBE PACKING STYLE MATTE TIN PLATING BROWN COLOR ROHS PART NO. 料號 C0100-XXNZXN00R
Helen 2024/3/26	M M 1 OF 1		

1 2 3 4 5 6 7 8