

PCB Layout

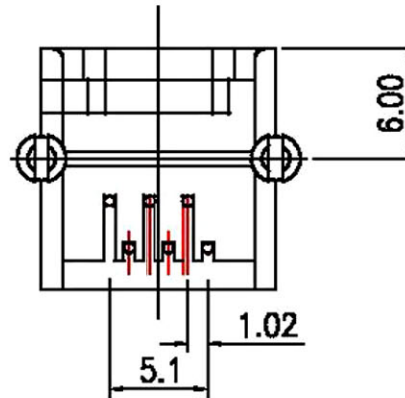
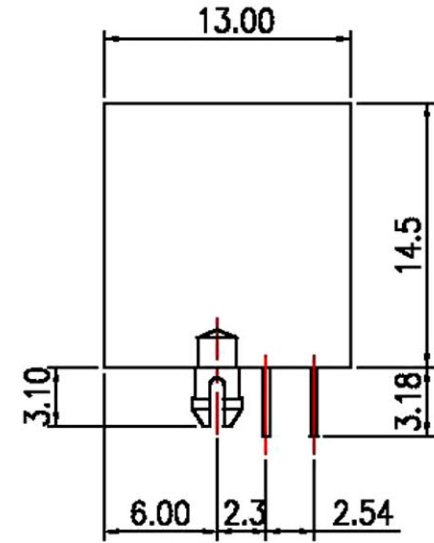
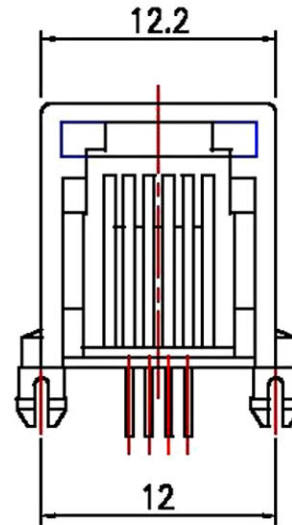

Materials

Housing: Glass filled Polyester UL94V-0, Black OR GREY  
 Contact: 0.45mm Diameter Phosphor Bronze Gold Plating  
 Over Nickel.

Electrical Characteristics:

Insulation Resistance: 500MΩ Min.  
 Contact Resistance: 30mΩ Max.  
 Withstand Voltage: 1000VAC 1minute.  
 Current Rating: 1.5A

RoHS Compliant		HSM 玄茂科技股份有限公司 HSUAN MAO TECHNOLOGY CO., LTD.	
APPD. 核准	SCALE 比例 参考	TOLERANCE 零件公差 0 ± 0.25 .00 ± 0.15 ANG. ± 3°	PART NAME 品名 SIDE ENTRY MINI L/P PCB JACK 6P6C W/O PANEL STOP SPLIT FOOT ROHS
DWG. 製圖 Helen	UNIT 單位 MM	SIZE 紙張尺寸 A4	PART NO. 料號 C0059-66ABXX00R
DATE 制表日 2012/9/19	PAGE 張數 1 OF 1	REV. 版本 B	