

Section A-A'

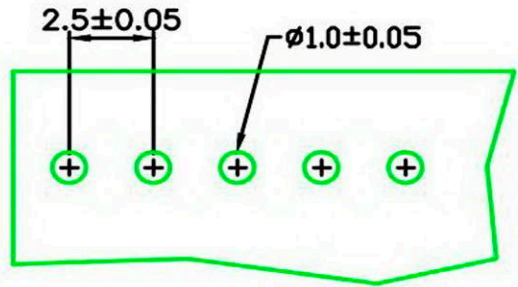
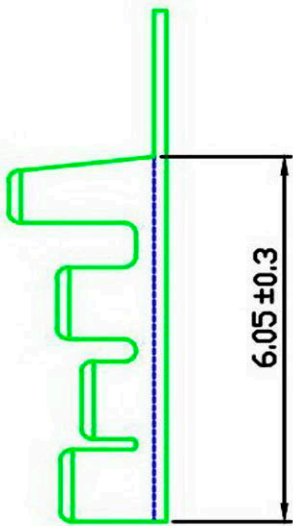
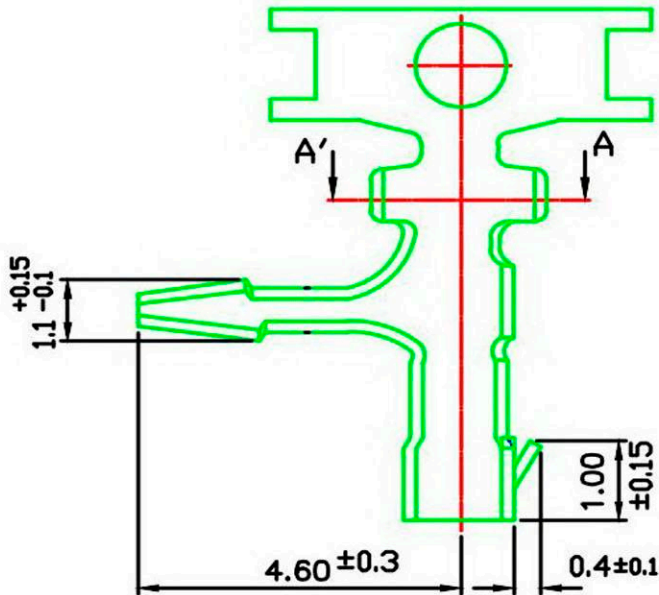

P.C.BOARD LAYOUT

### Specifications & Ordering Information:

THICKNESS	Material	Insulation O.D.	Finish	Wire Range	Quantity/Reel
0.2	BRASS	1.6~1.2 mm	Tin-Plated	AWG#22~#28	10,000 PCS

PITCH BETWEEN POLES:2.5mm  
 CURRENT RATING:2A  
 VOLTAGE RATING:250V  
 CONTACT RESISTANCE:INITIAL VALUE/10mΩ max.  
 AFTER ENVIRONMENTAL TESTING/20mΩ max.  
 INSULATION RESISTANCE:800 MΩ (min.)  
 WITHSTAND VOLTAGE:1000V AC/MINUTE  
 TEMPERATURE RANGE:-25°C TO +85°C  
 APPLICABLE WIRE:AWG#22 TO #28

RoHS  
Compliant

**HSM** 玄茂科技股份有限公司  
HSUAN MAO TECHNOLOGY CO., LTD.

APPD. 核准	SCALE 比例	TOLERANCE 容許公差	PART NAME 品名
DWG. 製圖	UNIT 單位	SIZE. 線規尺寸	2.5mm TERMINAL BRASS MATERIAL TIN PLATING AWG22~28 1R=10KPCS ROHS
DATE 制表日	PAGE 張數	REV. 版本	PART NO. 料號
2015/11/2	1 OF 1	B	T2502-TBJ00000R

Helen